

HP Designjet multi-roll feeder (for the 1000 series) Assembly and Set-Up Instructions

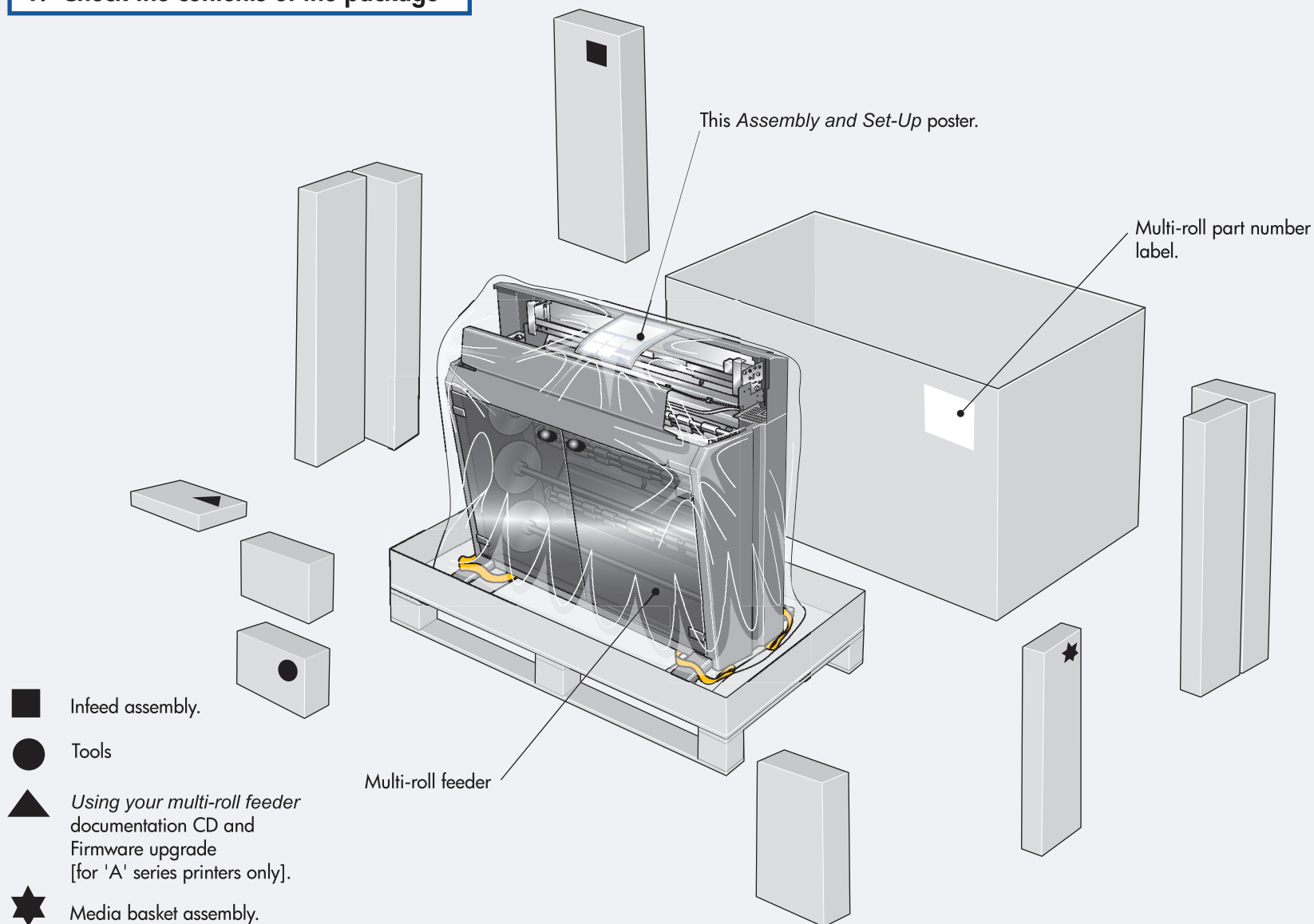

1. Check the contents of the package



Check the items shown and notify your supplier if any are missing. Do not open the items until you are prompted to do so on *this Poster*. The packaging varies between models; there may be additional items in the box

Contents of This Poster

1. Check the contents of the package.
2. Removing the packaging.
3. Removing the multi-roll feeder from the shipping container.
4. Upgrading the firmware module on your printer.
5. Removing the stand from your printer.
6. Attaching the printer to the multi-roll feeder.
7. Setting up your printer for the multi-roll feeder.
8. Stocking and loading media.
9. Configuring the loaded roll(s) for the printer.
10. Assembling the media basket.

The information on this poster applies to the following HP products:
HP Designjet multi-roll feeder (for the 1000 series)

Read these instructions carefully...

and complete each stage before you start the next.

What You Will Need to Do the Job

You will need 2 or 3 people to do some of the steps in this poster. See the descriptions that follow for details—a symbol like this is used:



You are recommended to have a floor area of approximately 6 square metres for unpacking and assembling your multi-roll feeder.

The time required to unpack, assemble and set up the hardware is about 60 to 90 minutes, depending on the model and components (e.g. the stand).

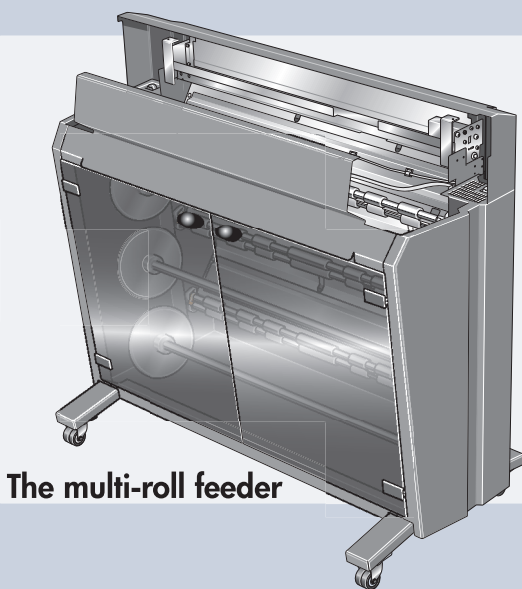

The multi-roll feeder

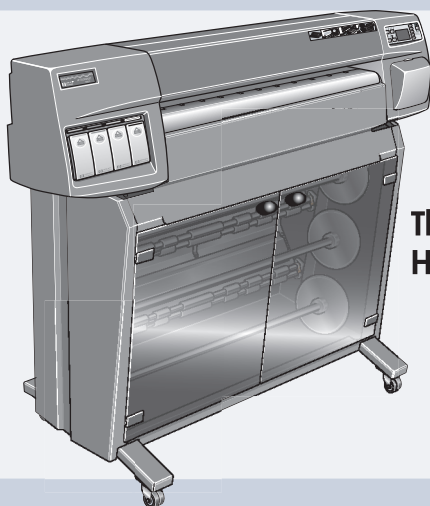

The multi-roll feeder and
HP Designjet 1000 Series Printer

2. Removing the packaging

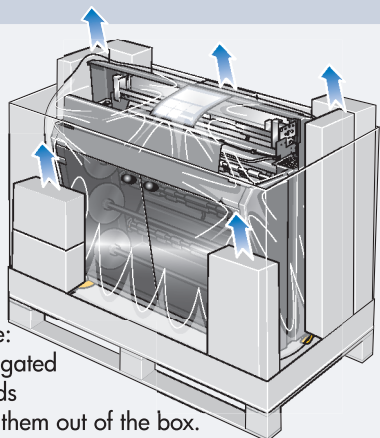

1. Remove:
- The corrugated safeguards by lifting them out of the box.
 - The outer sleeve by lifting it up and over the multi-roll feeder

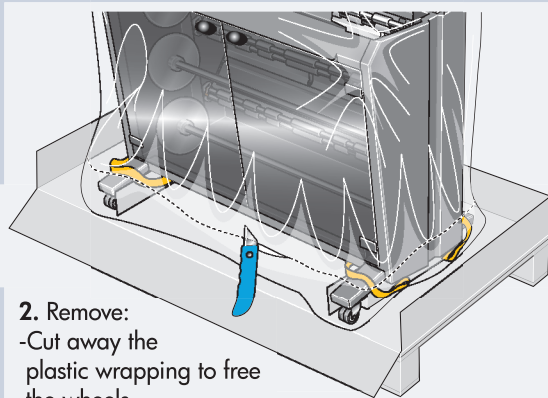

2. Remove:
- Cut away the plastic wrapping to free the wheels.
 - The boxes containing the infeed assembly, tools and the documentation CD.

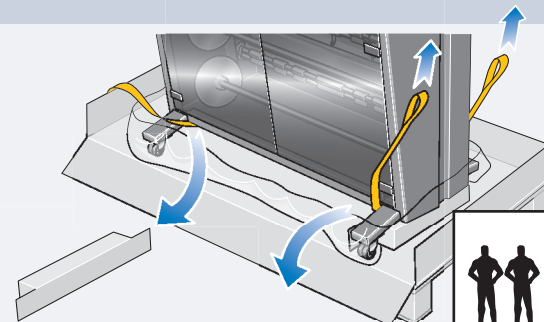

3. Remove:
- The left securing block by lifting the multi-roller on the left side using the lifting belt.
 - The right securing block by lifting the multiroller on the right side using the lifting belt.

3. Removing the multi-roll feeder from the shipping container

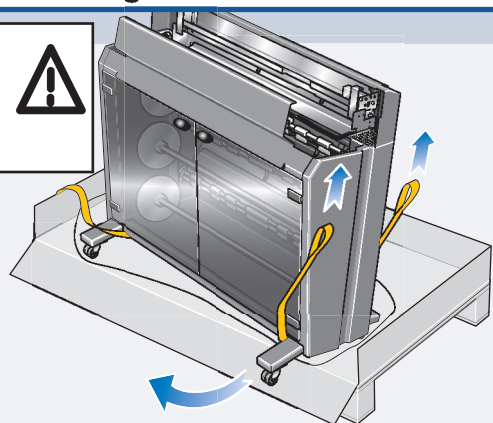
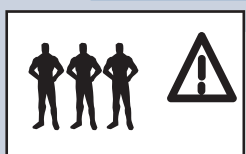

1. Using the lifting belt on the right side, roll the right side of the multi-roll feeder off the shipping container.

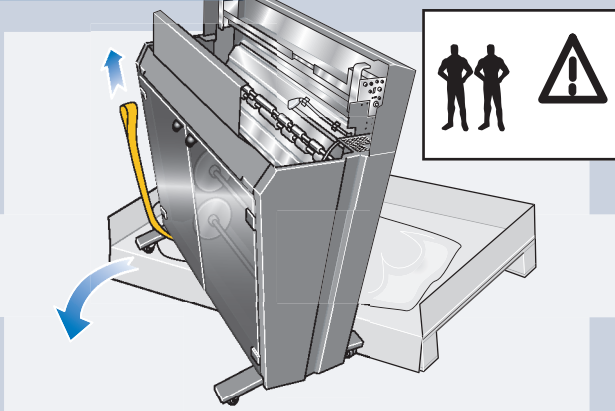

2. Using the lifting belt on the left side, roll the left side of the multi-roll feeder off the shipping container.

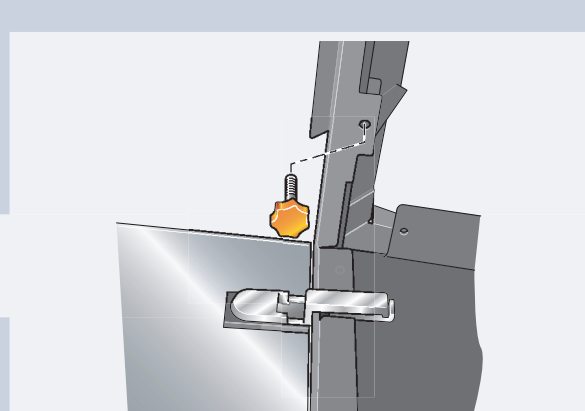

3. Open the doors and remove the star screws that hold the front cover to the cabinet.

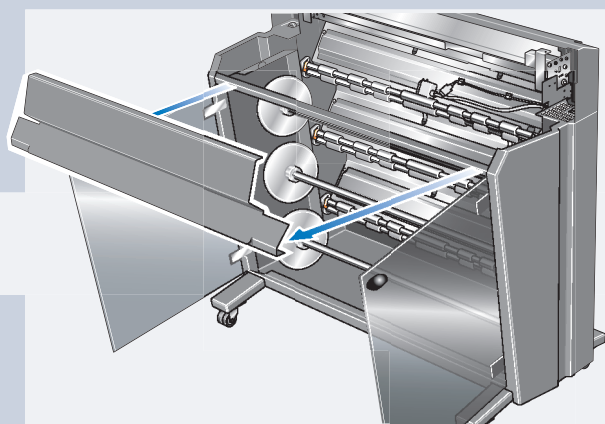

4. Remove the front cover.

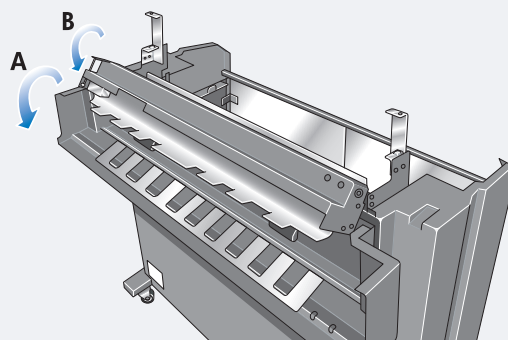

5. Lift back the rear cover of the multi-roll feeder (A) and then the motion controller assembly (B).

For printer models C6074A and C6075A ('A' series) go to section 4. Upgrading the firmware module on your printer.

For 'B' series printers, do one of the following:

- if you are attaching a new printer to the multi-roll feeder, follow the instructions that came with your printer to remove it from the shipping container only, and then go to section 6. Attaching the printer to the multi-roll feeder in this poster.
- If your printer is on a stand, then go to section 5. Removing the stand from your printer

4. Upgrading the firmware module on your printer (Model Numbers C2394B and C2394C only)

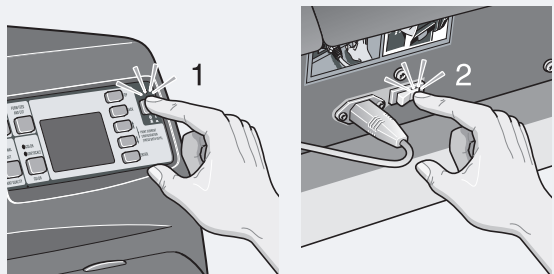

1. Turn off the printer at the front panel, then turn off the power isolator switch at the back of the printer.

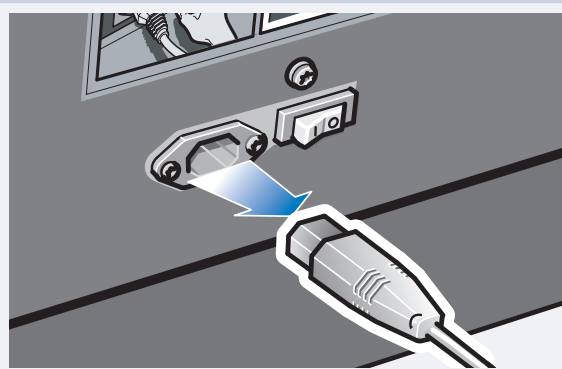

2. Disconnect the power cord and unclip from rear of printer.

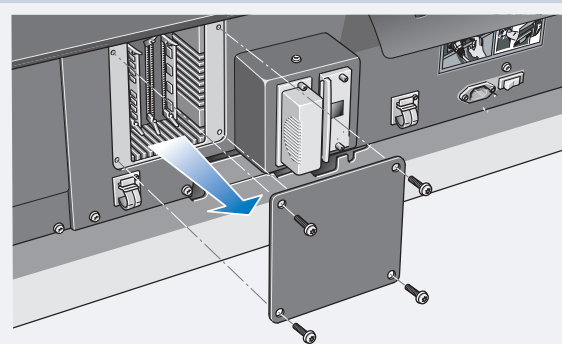

3. Unscrew the four screws and remove the cover plate at the back of the printer.
CAUTION: Your firmware module is in the slot on the right.

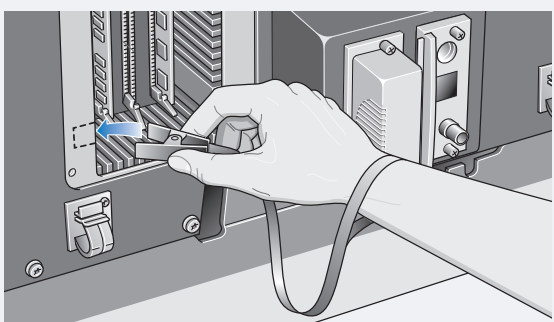

4. **WARNING**
To avoid damage to electronic components by electrostatic discharge, put on a grounding wrist strap and attach to a metal part of the printer, or touch a metal part when removing and inserting the module.

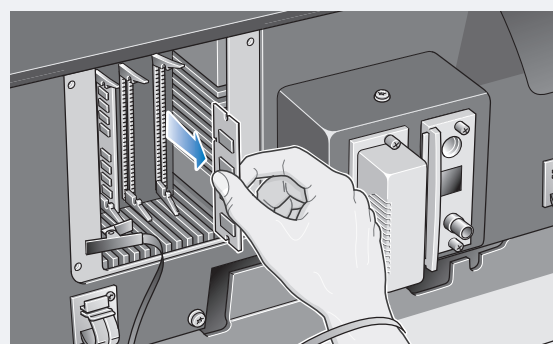

5. Push down the lower locking tab, push up the upper locking tab and remove the firmware module. Take care that it does not fall out.

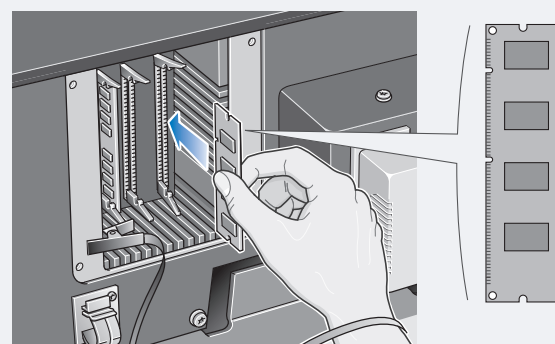

6. Take the upgrade module out of its bag. Hold the module by its edges with the non-metallic edges toward you. Carefully push the top edge of the module into the slot.

4. Upgrading the firmware module on your printer (continued)

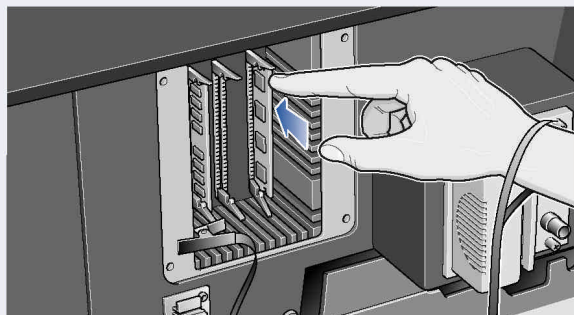

7. Continue pushing the top edge of the upgrade module into the slot until you feel it "click" into position. At the same time you will see that the top locking tab locks into position.

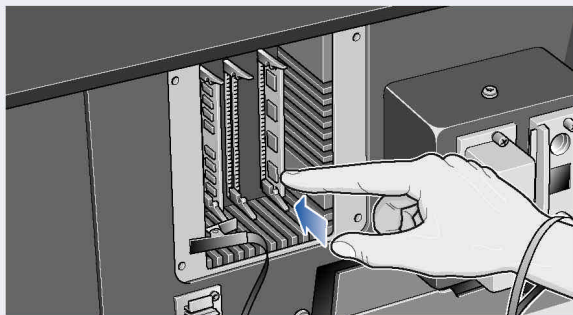

8. Carefully push the bottom edge of the upgrade module into the slot until you feel it "click" into position. Again, you will see that the bottom locking tab locks into position.

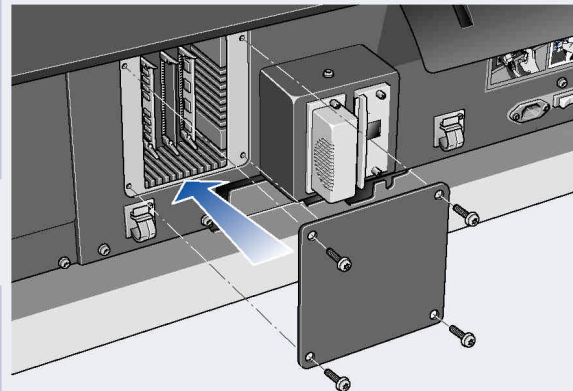

9. Remove the grounding wrist strap and re-install the cover plate using the four screws.

10. Verify correct installation of the upgrade module as follows:

Connect the power cord at the back of the printer, turn on the power isolator switch, and turn on the printer at the front panel.

The printer will perform the initialization procedure and on successful completion the front panel will display **Ready** status.

If you need to install any additional memory, a hard disk, or new LAN card, do this **NOW**.

Now go to section 5. Removing the stand from your printer.

5. Removing the stand from your printer

NOTE: If you need to upgrade the firmware module on your printer, do this before removing the printer from the stand (refer to section 4. Upgrading your printer).

NOTE: Do not remove the Ink Cartridges, Printheads and Printhead Cleaners.

Remove media from the printer

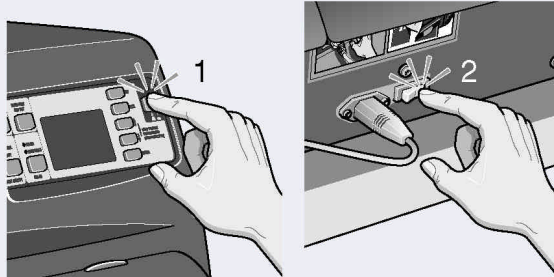

1. Turn off the printer at the front panel, then turn off the power isolator switch at the back of the printer.

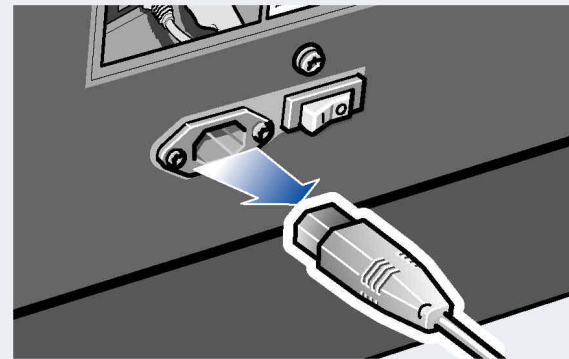

2. From the rear of the printer disconnect the power cord, and the parallel and network cables if present.

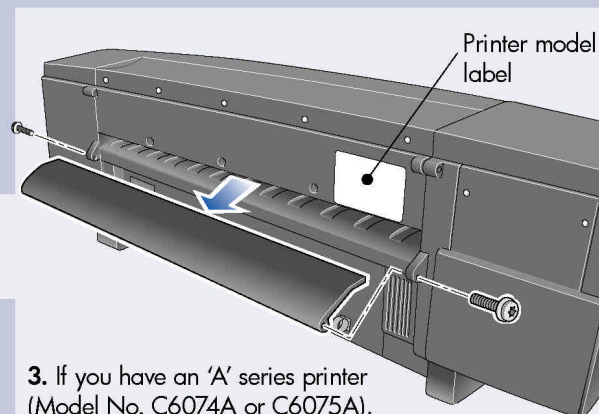

3. If you have an 'A' series printer (Model No. C6074A or C6075A), from the back of the printer remove the plastic profile by loosening the two screws on the left and right side.

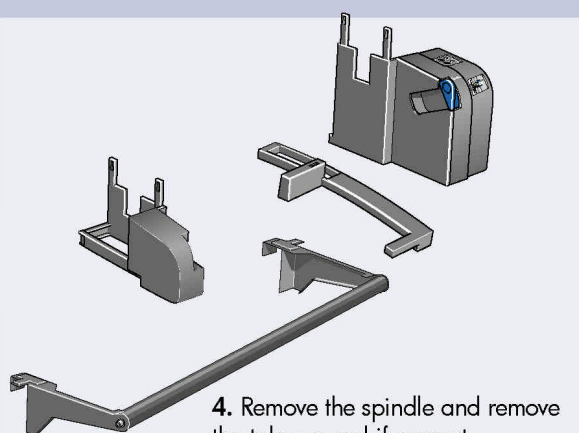

4. Remove the spindle and remove the take-up reel if present. Lock the wheels on the printer stand.

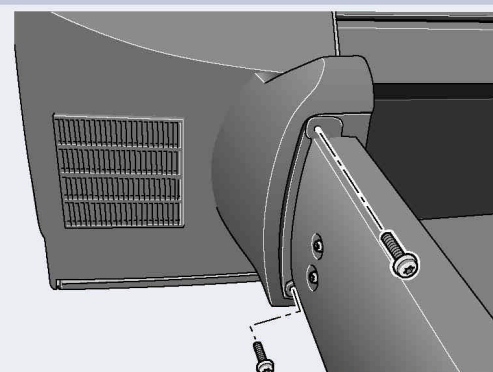

5. Remove printer body from the stand assembly by removing the four screws (2 each side). **CAUTION:** The printer is NOT now fixed to the stand.

6. Attaching the printer to the multi-roll feeder

If you need to install any additional memory, a hard disk, or new LAN card, do this **NOW**. Refer to the documentation that came with your upgrade.



1. If you are installing a new printer, cut away the plastic covering and remove the spindle, and then remove the end packing pieces.

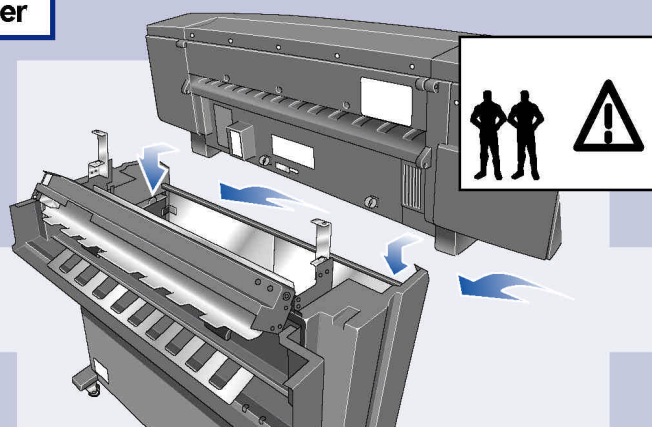

2. From the front towards the rear, lift the printer body onto the multi-roll feeder, aligning the printer body slots with the noses on the multi-roll feeder.

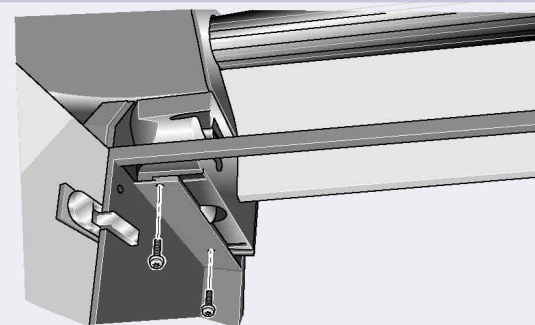

3. Insert the two screws (bag A) with washers through the holes and into the holes in the printer body on the left and right. Do not tighten. To find the screw threads you may need to slightly adjust the printer position by moving it towards the front or back of the multi-roll feeder.

6. Attaching the printer to the multi-roll feeder (continued)

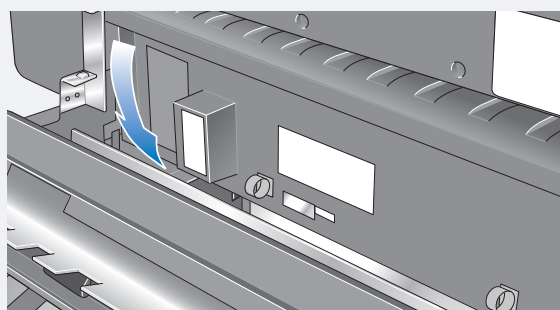

4. From the rear of the multi-roll feeder, pass the parallel and serial cables at the back of the multi-roll feeder connector panel into the multi-roll feeder media cabinet so that they can be accessed from the front.

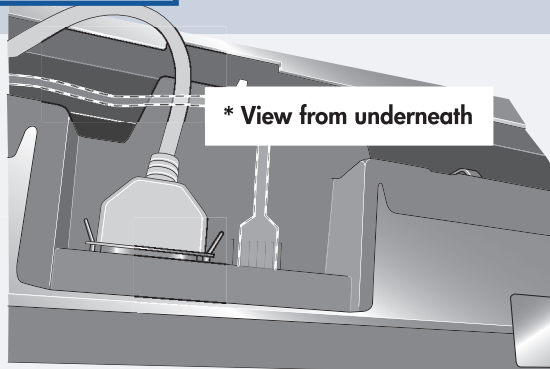

5. Go to the front of the multi-roll feeder, open the doors and from inside the cabinet connect the parallel cable (and the serial cable printer Model Nos. C6074A and C6075A only).

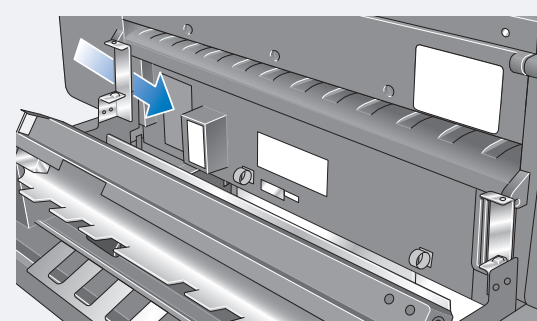

6. At the rear of the multi-roll feeder, insert the printer power cord, and the network cable if present, through the left rear side of the multi-roll feeder and connect to the rear of the printer body. Clip in the cables.

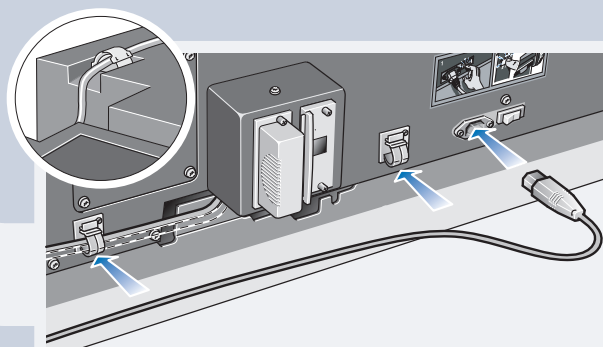

7. Connect the power cord to the rear of the printer and secure the cables and power cord using ALL clips provided, especially the clip at the rear of the multi-roll feeder (see detail).

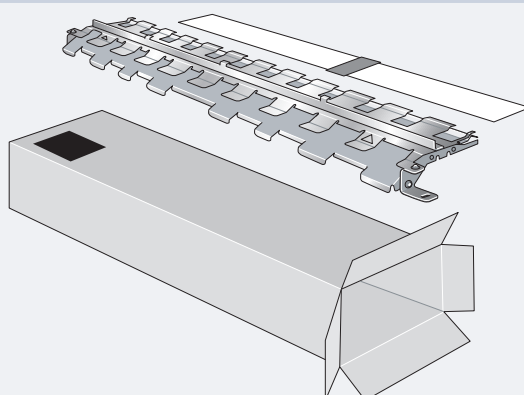

8. Unpack the infed assembly and remove the cardboard strip.

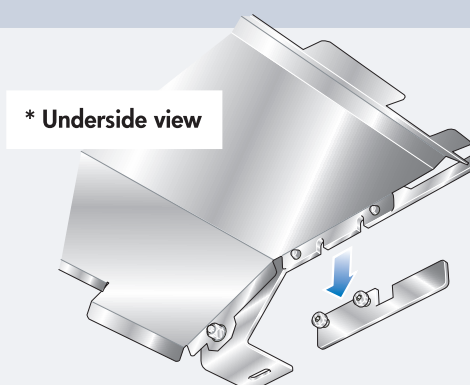

9. If you have a 'B' series printer (Model No. C6074B or C6075B), remove the brackets on each side of the infed assembly by loosening the two screws.

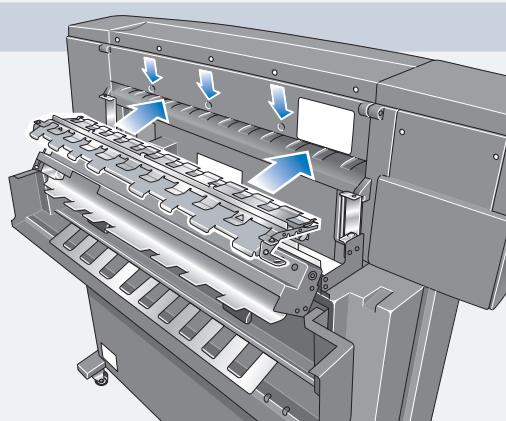

10. Push the infed assembly into the slot, making sure the three hooks fit into the recesses on the rear of the printer body.

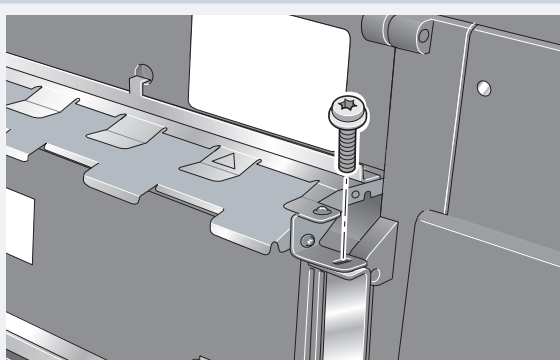

11. Screw (bag B) the infed assembly to the multi-roll feeder at left and right.

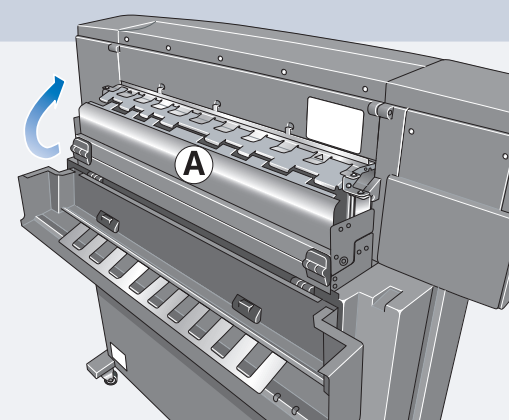

12. Return the motion controller assembly (A) to its upright position.

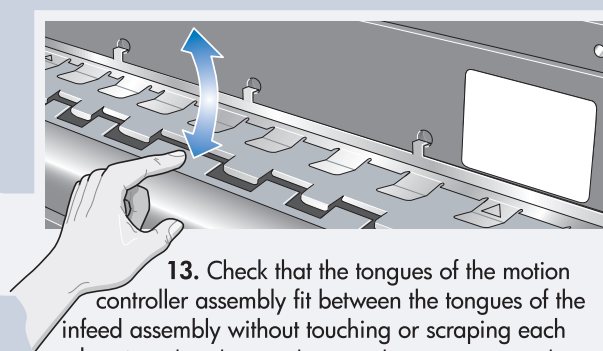

13. Check that the tongues of the motion controller assembly fit between the tongues of the infed assembly without touching or scraping each other. (To adjust the gaps between the tongues, move the printer body left or right until the tongues of the motion controller assembly are perfectly centered in the slots of the infed assembly, then tighten the four screws holding the printer body to the multi-roll feeder).

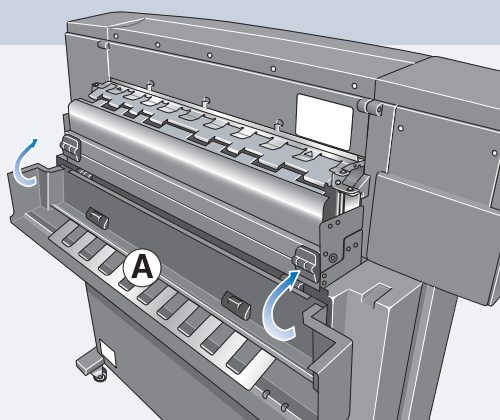

14. Close the rear cover of the multi-roll feeder (A). Go to the front of the unit.



15. If you have a new printer, remove the tape securing the printer cover, open the cover and remove the Carriage packing piece.

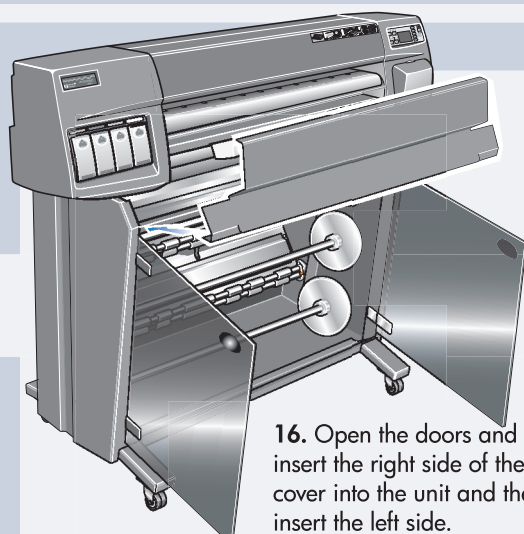

16. Open the doors and fully insert the right side of the front cover into the unit and then insert the left side.

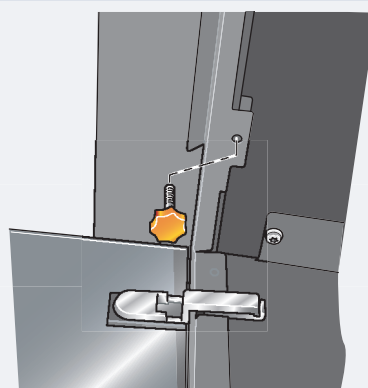

17. Insert the star screws left and right and tighten to secure the cover.

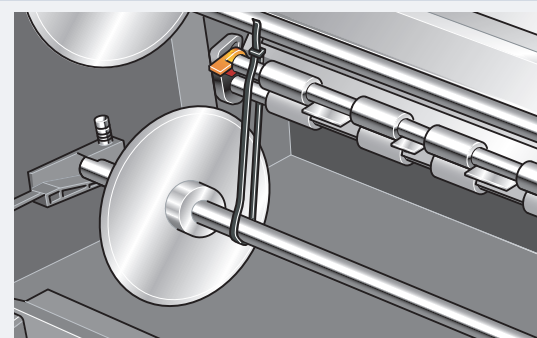

18. Inside the cabinet, remove the plastic ties that secure the rollers and the spindles.

7. Setting up your printer for the multi-roll feeder

If you are switching on your printer for the first time, refer to the following sections in the Setup Guide that came with your printer, and then come back to this poster and carry out the instructions below.

NOTE: Information in your Setup Guide applies to all printer models in the Designjet 1000 Series, so information and/or illustrations may not reflect exactly the model you have.

Setup Guide Procedures

Switch On
HP No.80 Supplies
Configuring the HP JetDirect Print Server
Print a Test File

Also, follow the instructions that came with your Macro Installer CD to install your new drivers.

NOTE: To access the rear of the printer body, open the back cover of the multi-roll feeder and lift back the motion controller assembly.

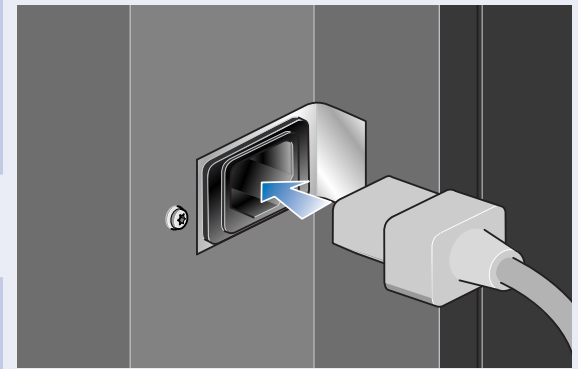

1. Plug in the Multi-roll power cord.



2. Switch the power isolator switch at the back of the multi-roll feeder to the LED ON position.



3. On the printer front panel press the down arrow key to select the Printer Setup menu and then press ENTER.

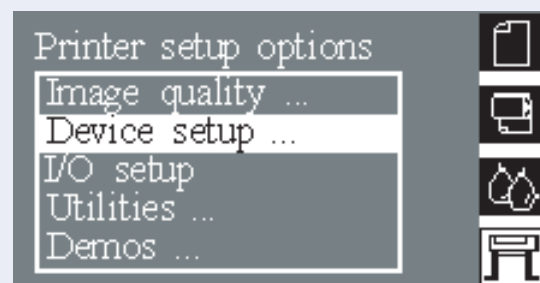

4. Press the down arrow key until Device setup is highlighted and then press ENTER.

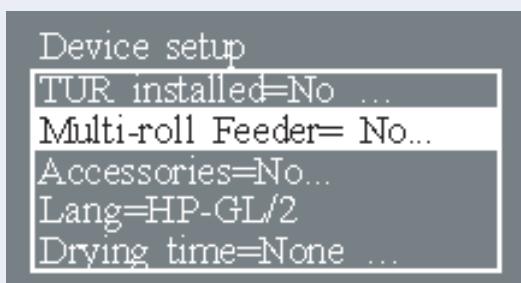

5. Press the down or up arrow keys until Multi-roll feeder is highlighted and then press ENTER.

Note: If a TUR is configured (TUR installed=Yes...), you need to uninstall it to see the Multi-roll Feeder option.

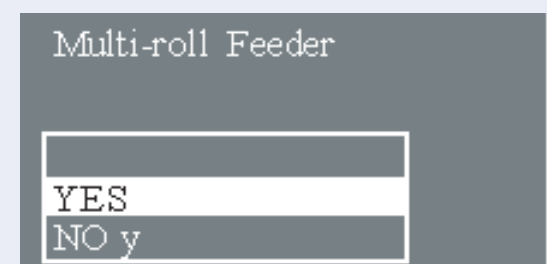

6. In the Multi-roll feeder menu press the up arrow key to select Yes and then press ENTER.

The following message is displayed:

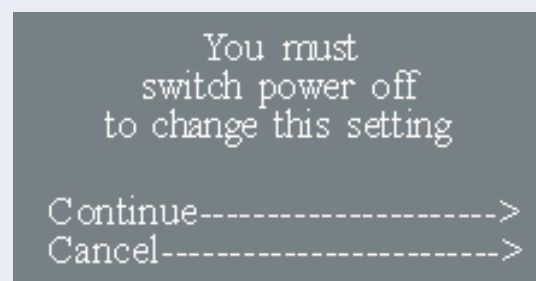

7. Press the down arrow key to continue.

The following message is displayed:

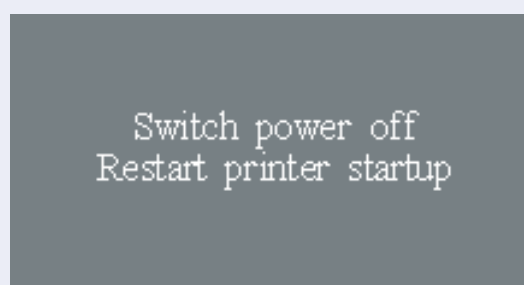

8. To turn off the printer, press the on/off pushbutton on the front panel.

The following message is displayed:

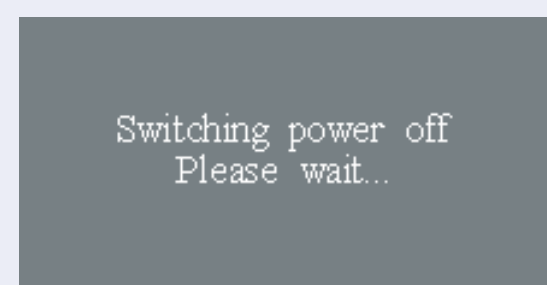

9. When the power LED is red, power on again by pressing the on/off pushbutton.

The printer will perform initialization procedures and will briefly display the following message.

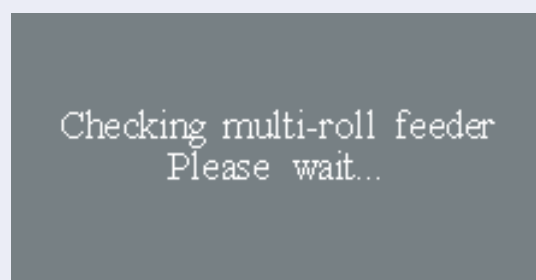

10. You are now ready to use your multi-roll feeder.

NOTE: If the following message is displayed, check that the multi-roll feeder is turned on at the connector panel (section 7, step1) and that the parallel cable is correctly connected between the multi-roll feeder and the printer (section 6, step 6).

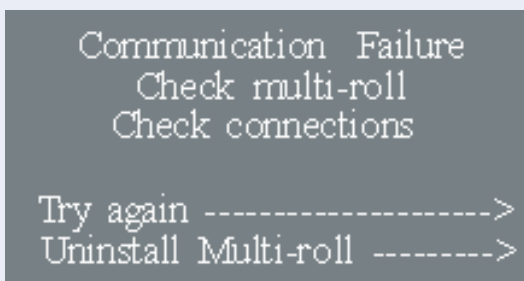

If you have checked the power and connection, press the down arrow key to try again. If you press the ENTER key the multi-roll feeder is uninstalled.

You are now ready to use your multi-roll feeder.

8. Stocking and loading media

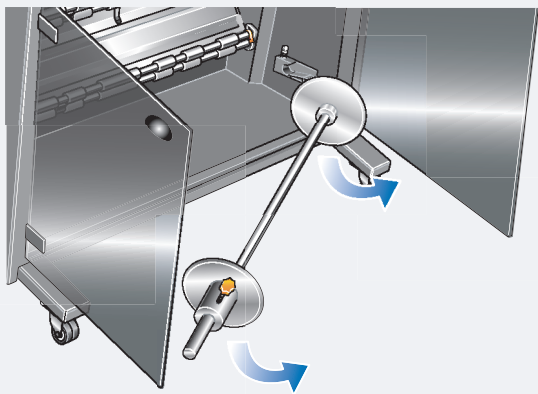

1. Remove the media spindle from the media cabinet.

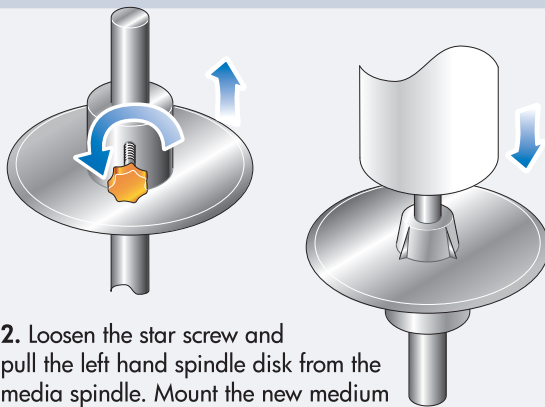

2. Loosen the star screw and pull the left hand spindle disk from the media spindle. Mount the new medium roll flush against the right hand spindle disk.

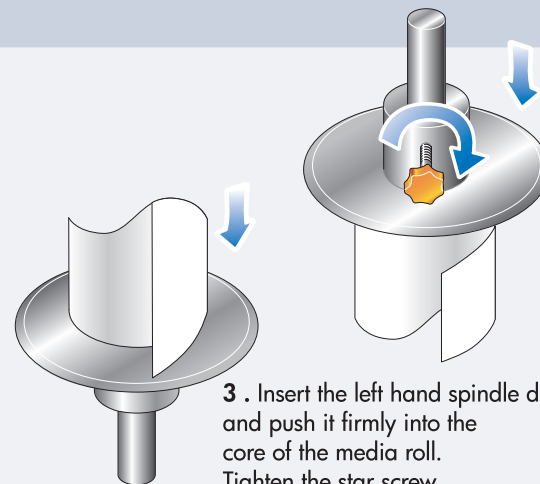

3. Insert the left hand spindle disk and push it firmly into the core of the media roll. Tighten the star screw.

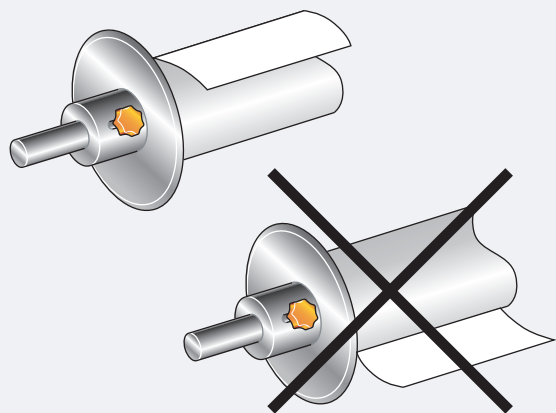

4. Place the media spindle into the media cabinet, right end first, on to the spindle retainers.

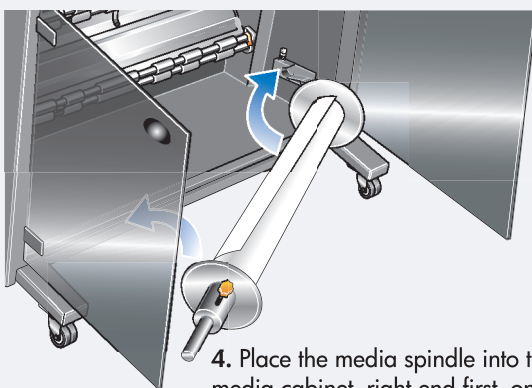

5. Press down the roller lever at the left and right side. This opens a slot between the rollers.

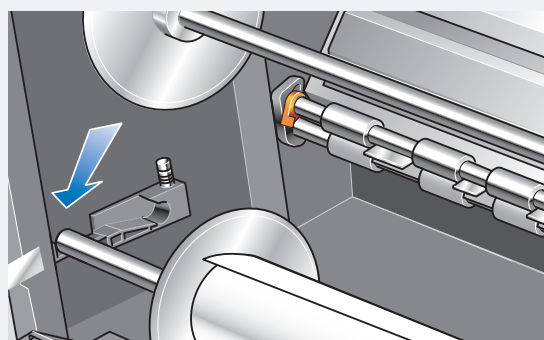

6. Place the roll in the park position. There is more space to feed the media from this position.

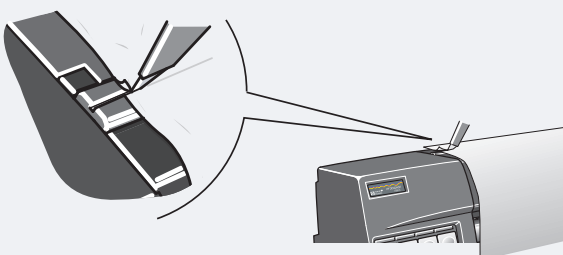

7. Make sure the edge of the media is straight. If necessary unroll the media over the cutting slot of the printer and make a clean cut.

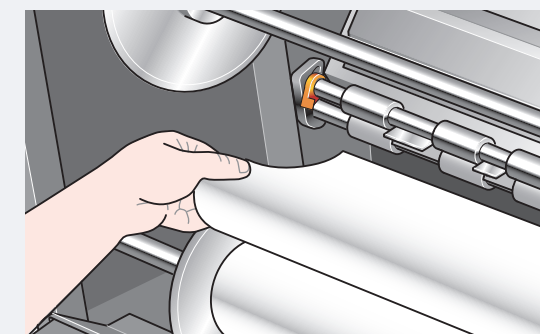

8. To insert the media, hold the media about 15cm from leading edge, and fold slightly.

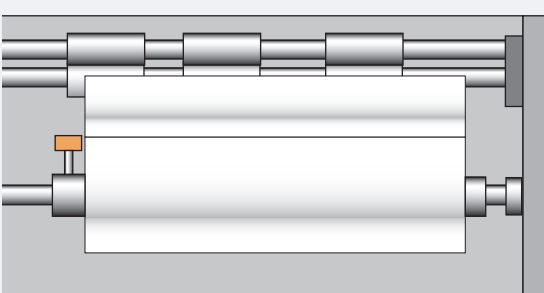

9. Make sure the media is aligned so that both sides of the leading edge are parallel to the infeed channel.

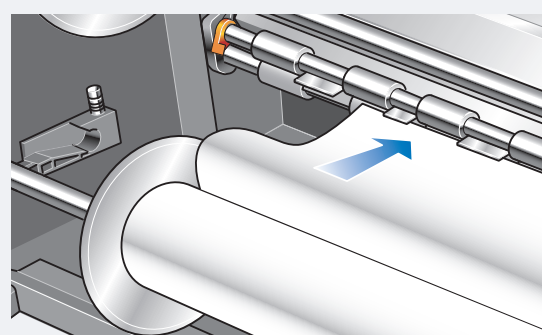

10. Feed the leading edge into the slot between the rollers. Use the top edge of the grey rubber rollers as a reference guide. Feed about 15 cm of media into the slot. You will hear a 'beep'.

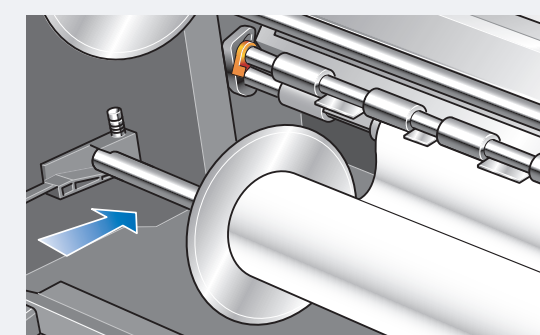

11. Place the media spindle fully into the spindle retainers till it locks. Do not lift the roller levers yet.

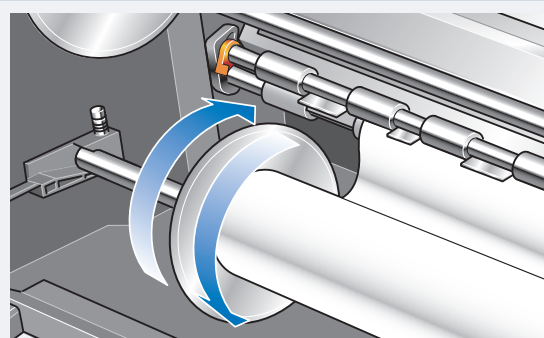

12. Turn the media roll 2-3 times clockwise. Then quickly turn it counter-clockwise until the media has an even tension.

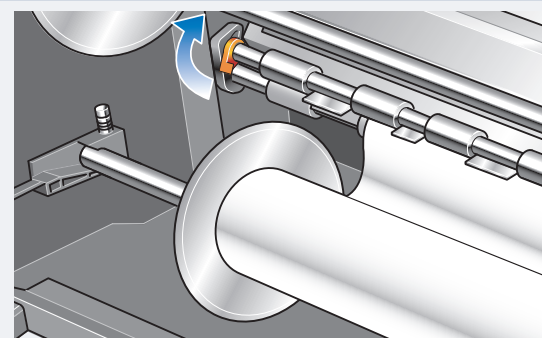

13. Now lift the roller levers.

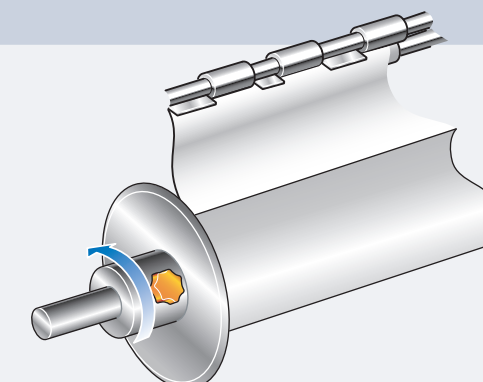

14. Pre-tension the media by turning the star screw on the left side of the spindle disk 5-7 times.

9. Configuring the loaded roll(s) for the printer

When a new roll is inserted, you will hear a 'beep' from the printer that prompts you to configure the roll of media you have loaded. The following message is displayed:

Configure New Roll
Press Enter to continue

1. Press ENTER to continue.

Select Media
Bright white inkj.
Plain Paper ...
Heavy coated paper
Coated paper
High-gloss photo
Press Enter to continue

2. Press the up or down arrow keys until the media type is highlighted and press ENTER to continue.

Select Width

36 in media roll
24 in media roll

Press Enter to continue

3. Press the up or down arrow keys until the media width is highlighted and press ENTER to continue.

The following message is displayed:

Load Media Now

Yes ----->
No ----->

4. Press the down arrow key to load media. The printer will check media alignment and will trim the leading edge.

10. Assembling the media basket

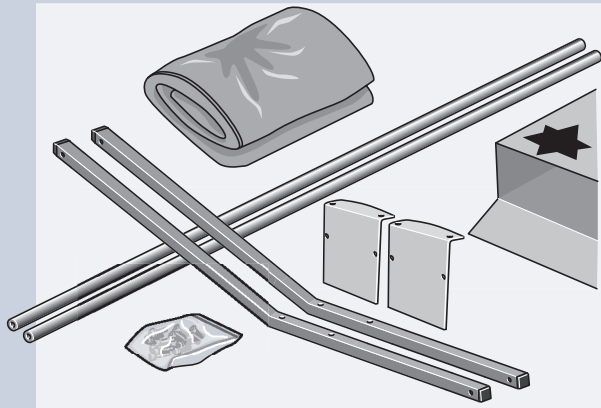

1. Unpack your media basket assembly.

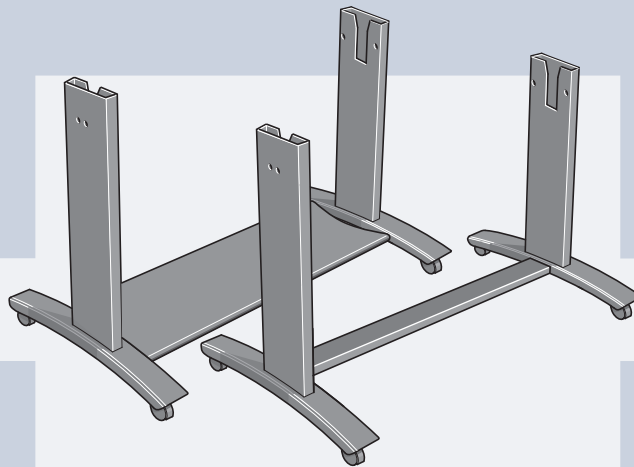

2. Prepare your printer stand like either of the ones shown above.

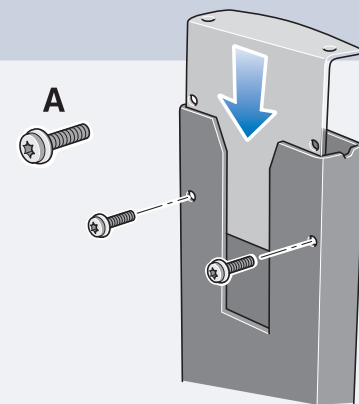

3. Insert the brackets (left and right) into the printer legs and insert two screws (type A) for each bracket.

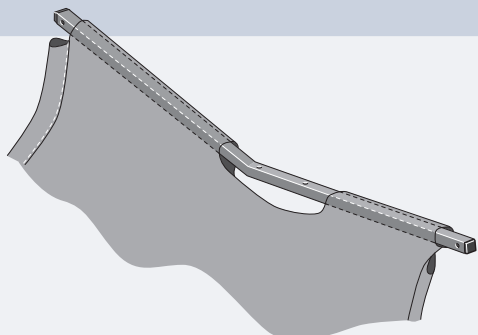

4. Insert the right and left bars into the side sleeves of the bag making sure the shorter sleeve corresponds to the side of the bar with the screw holes.

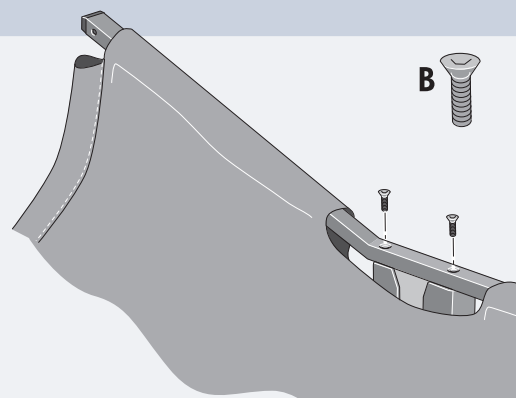

5. Insert two screws (type B) into both bars to fix to the brackets (left and right).

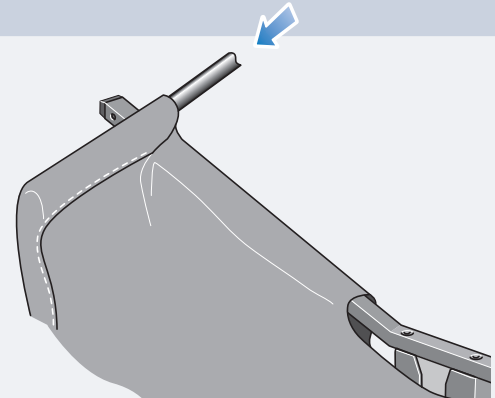

6. Insert the front and back rods into the sleeves of the bag and fix to the side bars.

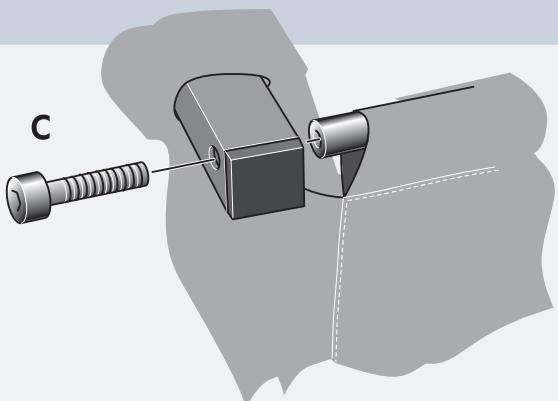

7. Use two screws (type C), one at each end, to fix each rod to the bars.

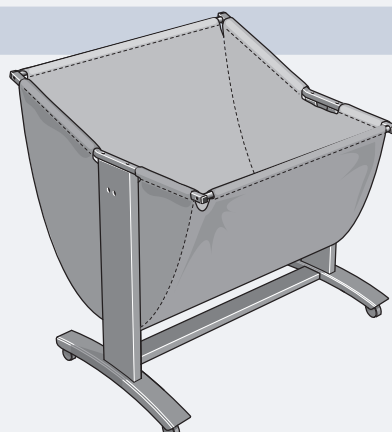

8. Now your media basket is ready to be used.

9. Your media basket should be positioned with the higher side facing the printer.

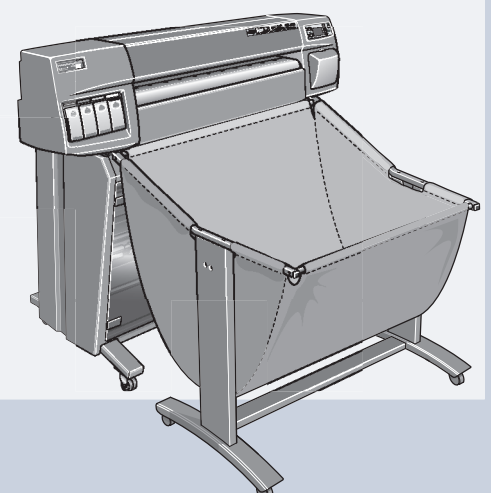



C2394-90001

Copyright Hewlett-Packard Company 2001
Part Number C2394-90001
First Edition September 2001
Printed in Singapore

Hewlett-Packard Company
Inkjet Commercial Division
Avda. Graells, 501
08190 Sant Cugat del Vallès
Barcelona
Spain